

## IMPORTANT INFORMATION

### Venue

#### Surface/Pendant - Installation Guide

SM1674/SM1675/SM1676/SM1677/  
SM1678/SM1679/SM1680/SM1681/  
PN1674/PN1675/PN1676/PN1677/  
PN1678/PN1679/PN1680/PN1681



Caution

Product Contains Magnets  
Magnets can adversely affect pacemakers.  
Do not place within 300mm of credit cards.

#### Disconnect electricity supply before installation

To be installed by qualified personnel only, in accordance with current building and wiring regulations.

When installing, we recommend wearing disposable gloves to avoid fingerprinting to the paint work of the luminaire.

Read leaflet fully before installation.

**Hacel**<sup>®</sup>  
Fluent in Lighting

THE SILVERLINK, WALLSEND, NEWCASTLE UPON TYNE,  
TYNE & WEAR, NE28 9ND

Technical: (0191) 280 9914

Email: [technical@hacel.co.uk](mailto:technical@hacel.co.uk)

Web: [www.hacel.co.uk](http://www.hacel.co.uk)

02/2024 - VI

#### Installation - Surface & Pendant

1

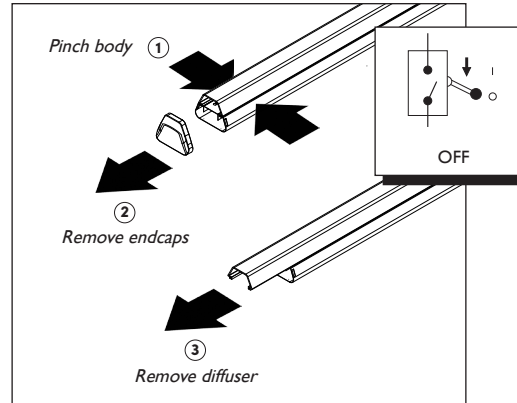

2

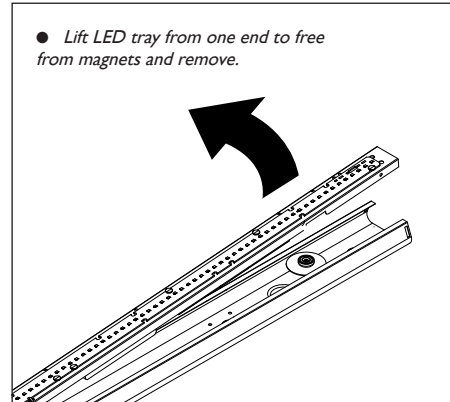

3

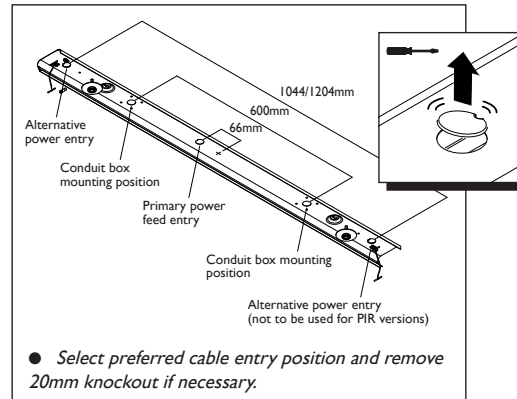

#### Installation - Surface Only

4

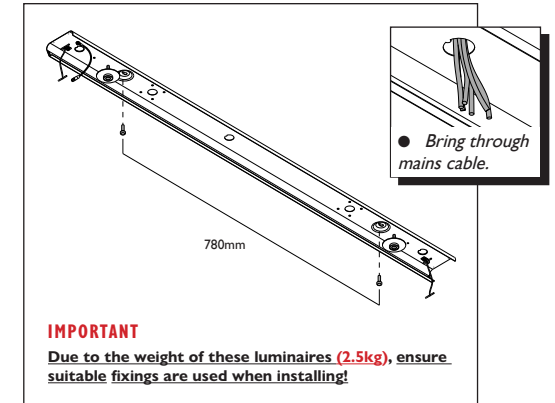

#### Installation - Pendant Only

4

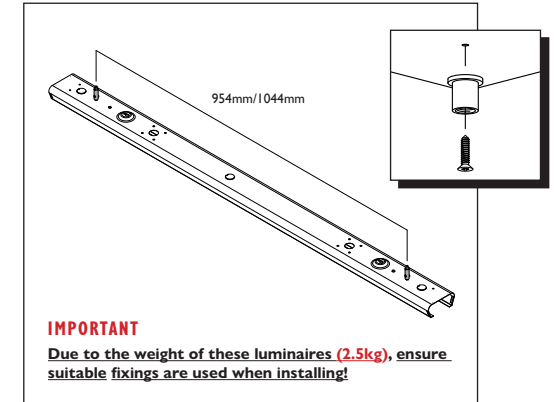

5

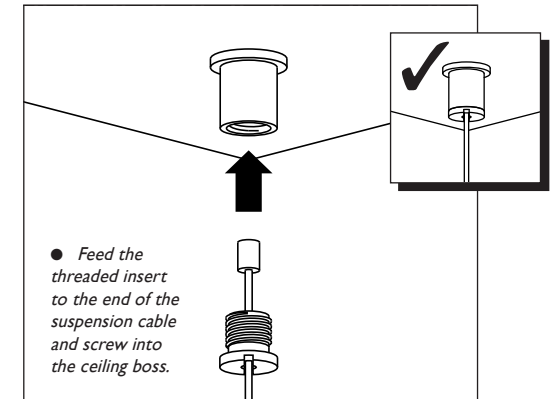

6

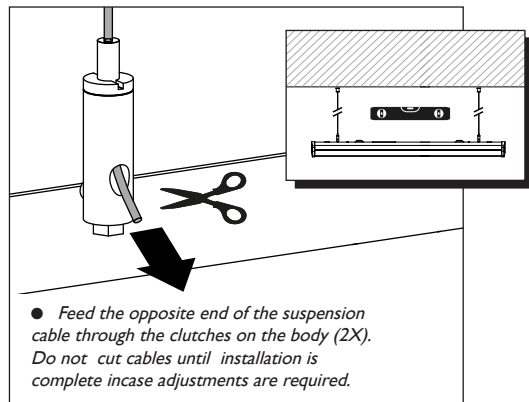

5

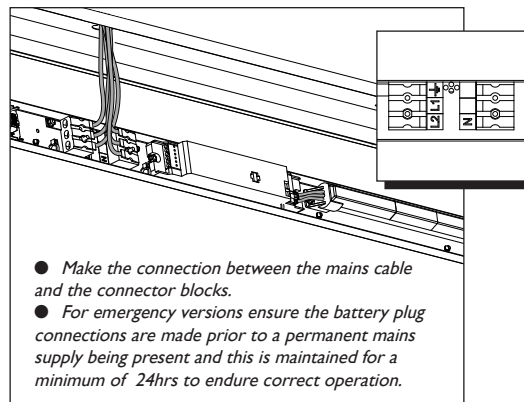

8

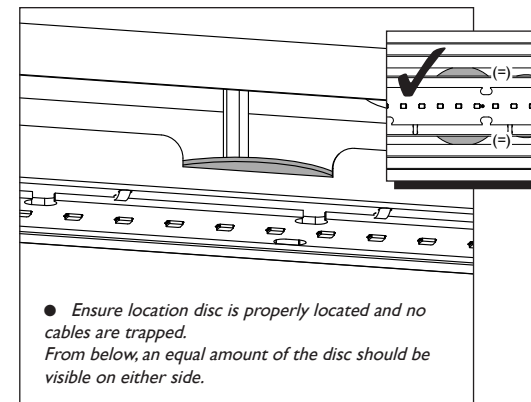

7

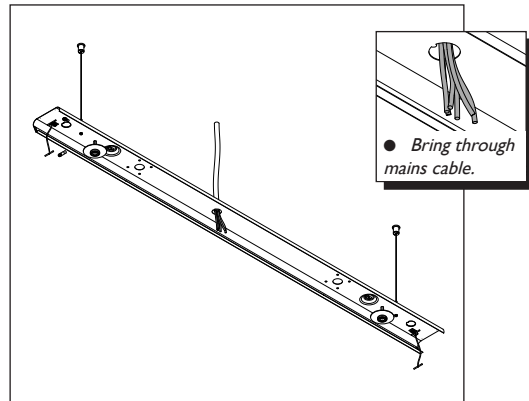

6

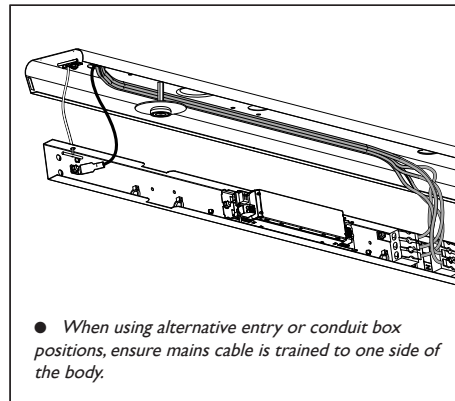

9

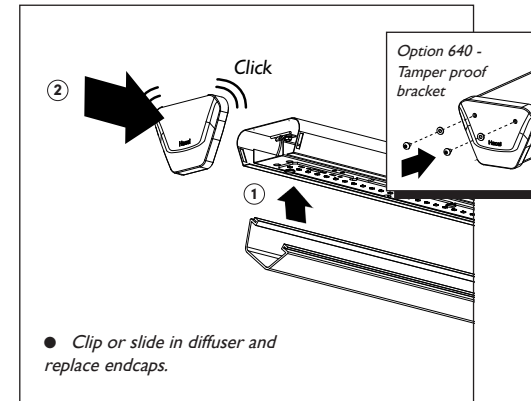

## Installation - Surface & Pendant

4

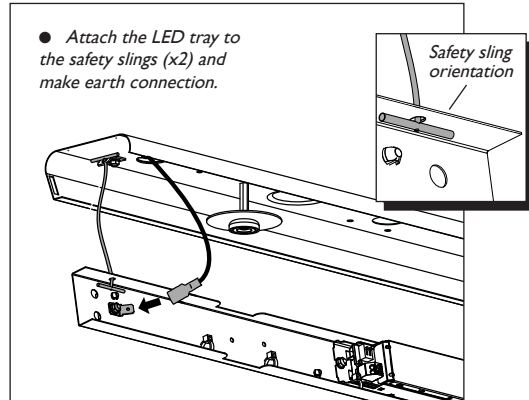

7

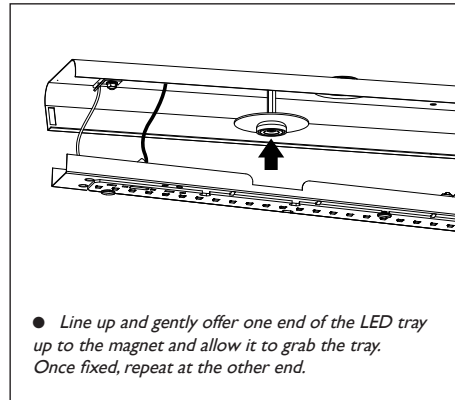

10

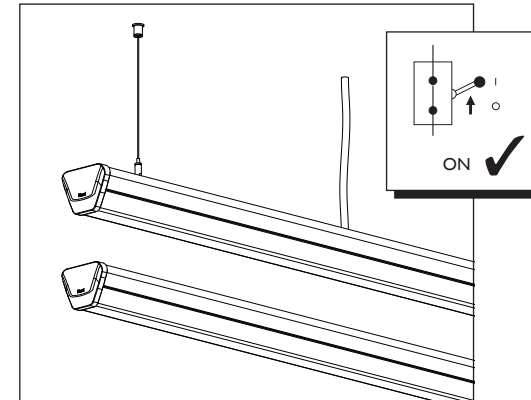

## PIR Sensor Installation

1

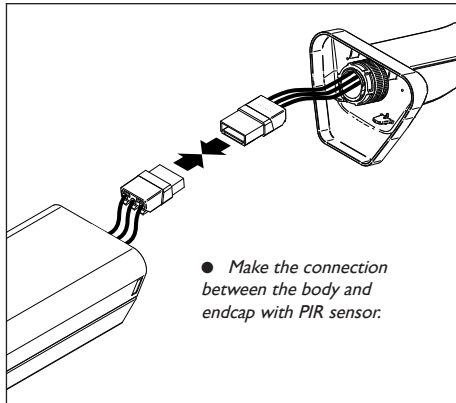

2

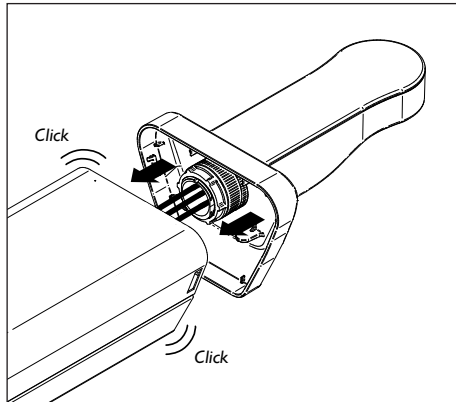

3

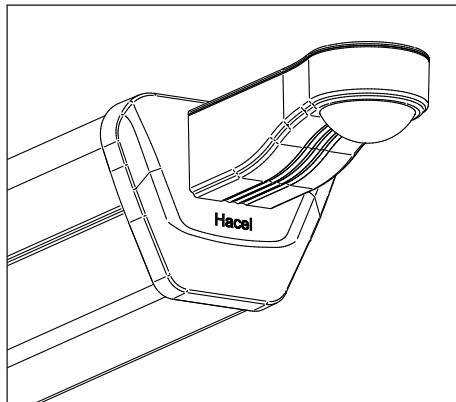

## Conduit/End Cable Entry

1

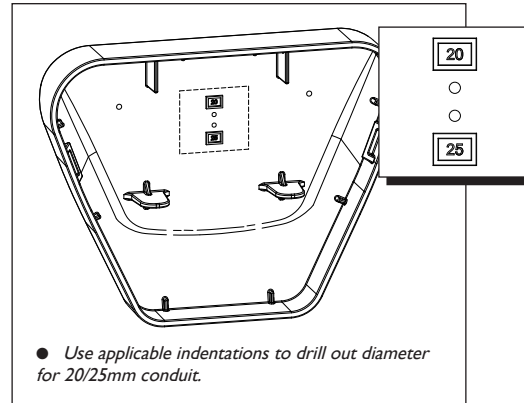

## Emergency Battery Replacement

1

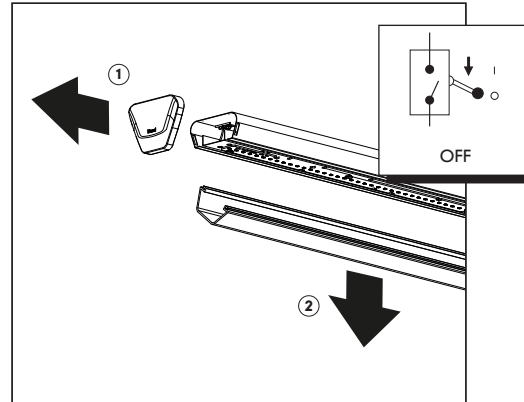

2

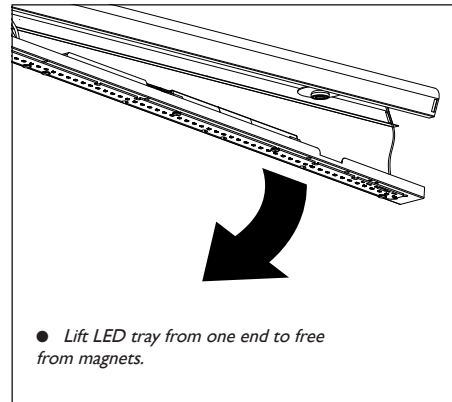

3

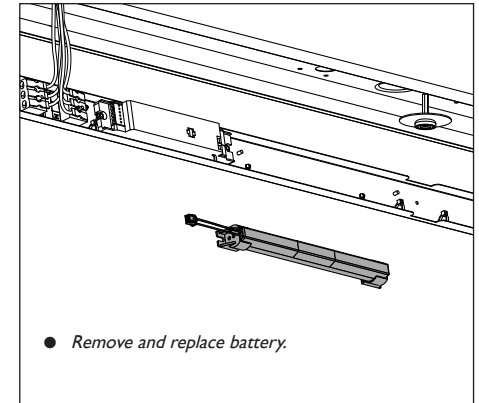

## Opinion 640 - Tamper-Proof Bracket

1

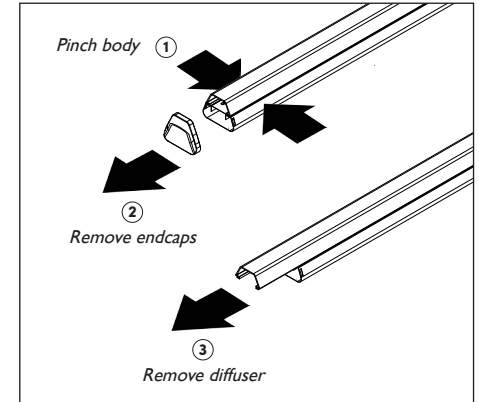

2

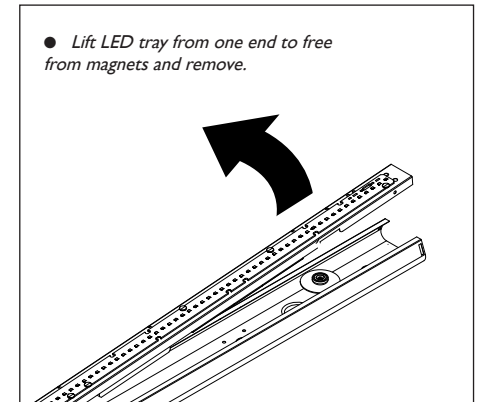

3

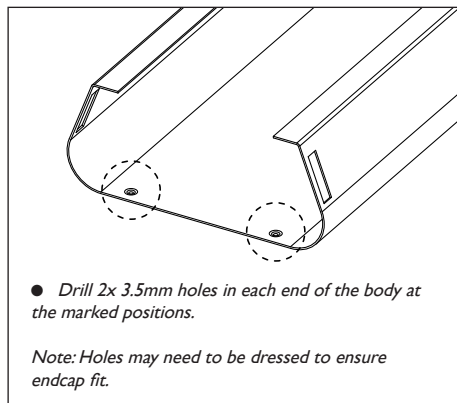

6

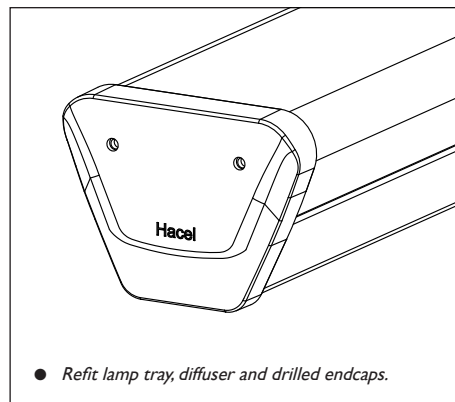

4

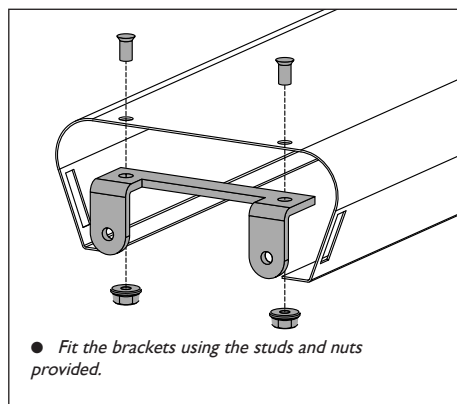

7

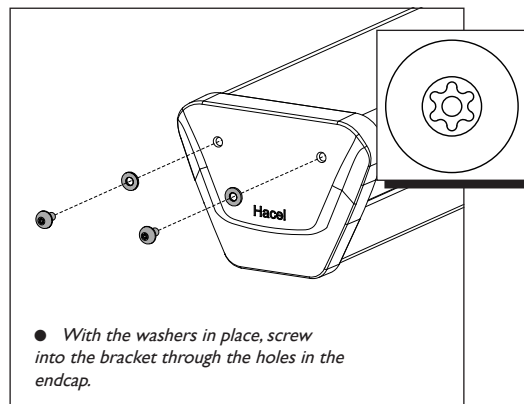

5

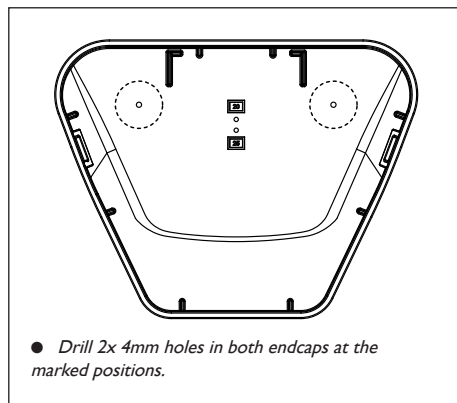

8

