

IMPORTANT INFORMATION

Emerge Plus SD1538/ID1539/PN1540
Emerge Eco SD1544/ID1545/PN1546

*Ensure electrical supply is isolated before fitting and/or making any electrical connections.
 Luminaire should be disconnected from the mains supply before any High Voltage Insulation tests are carried out.*

Surface Mount / Suspended

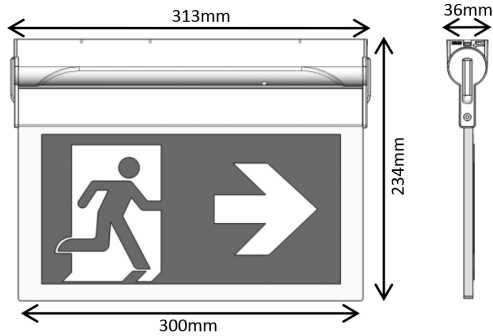

Wall Mounted

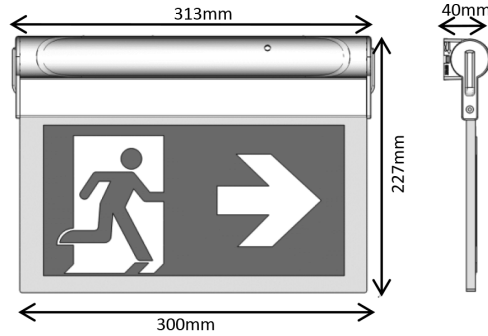

Product Dimensions - Recessed

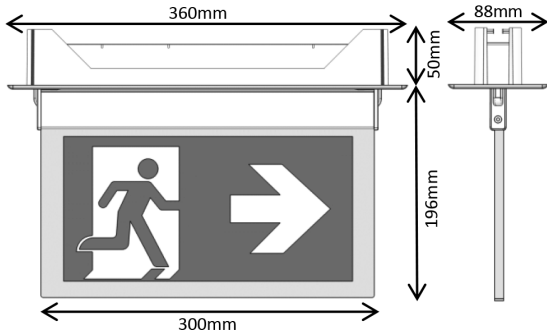

Product Specification

220-240Vac 50/60Hz ta: 0°C ... +35°C



Cable Size & Strip Length

0.75mm² – 1.5mm² (19 - 15AWG)
 Solid conductor or 7 stranded wire ends.

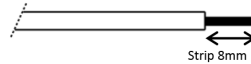

Wall/Surface - Fixing Centres

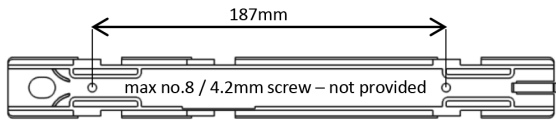

Cable Entry / Termination

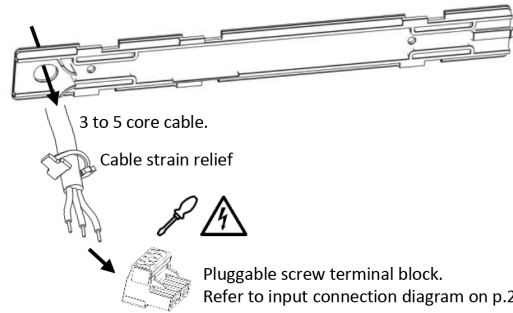

Recessed - Ceiling Cut Out

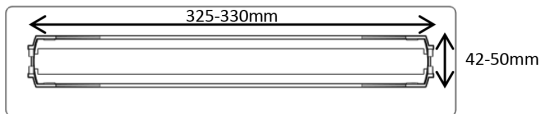

Wall/Surface Mount Fixing

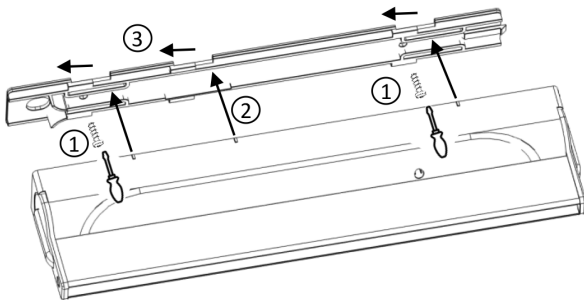

Recessed Fixing

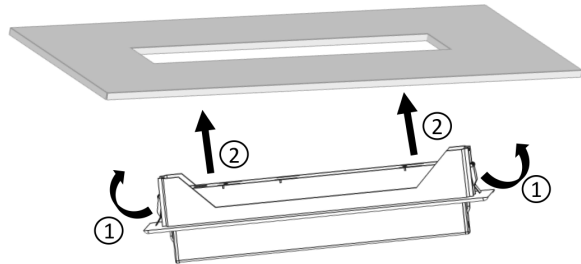

The main luminaire assembly is lowered through the recess plate and pushed firmly into place. This should take place before installation.

IMPORTANT INFORMATION

Suspended Fixing

Attach clutch assemblies to luminaire mounting bracket.

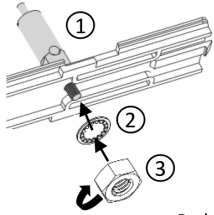

Pull a suspension cable through each of the ceiling couplers. (cables omitted for clarity)

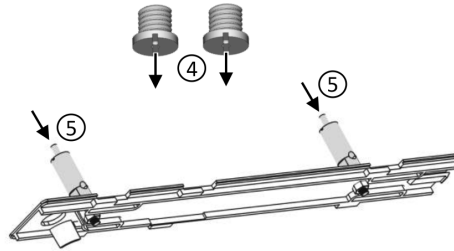

Push bare end of suspension cable into clutch assembly until desired suspension length is achieved. To release/adjust cables, compress the clutch, and cable can be moved freely. Excess suspension cable can be cut.

⑥ Ceiling couplers to be secured to mounting surface with 187 mm between centres.

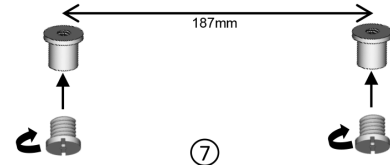

Screw the cable assembly into the ceiling couplers.

Attach Legend

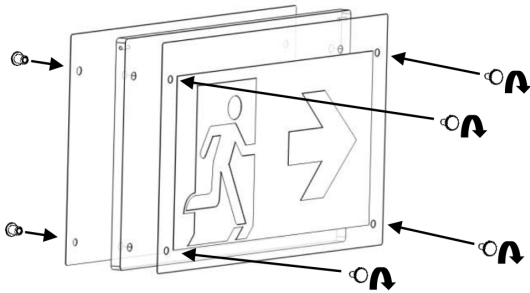

Barrel Nuts to affix white PVC backing and relevant ISO directional legend

Blade Installation

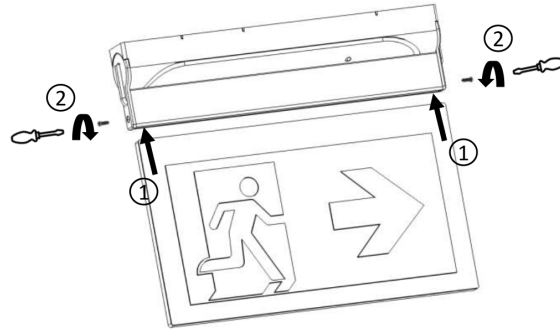

Battery Connections

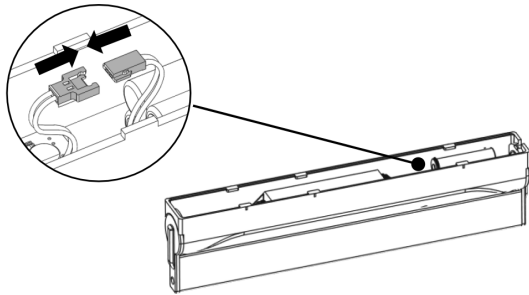

Input Connections

X 1 ABC*EFG 180	✓	✓	✓	✓	✓
X 1 ****E*G 180	x	x	✓	✓	✓

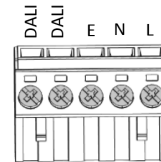

Maintenance

To remove luminaire from mounting bracket for access to battery and supply terminals, apply light pressure upward at the locking tab for it to disengage. Slide the luminaire body off in the direction shown.

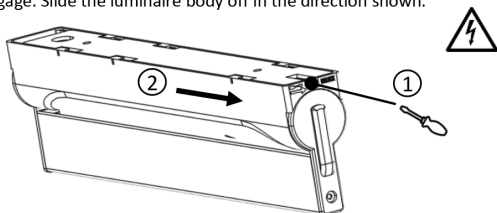

For recessed versions, if top-down access is restricted, the recess plate may first need to be removed from the mounting surface in its entirety.

Important Information

Emerge Plus and EmERGE Eco luminaires are suitable for indoor use only.

For battery replacement order codes, refer to the product datasheet.

The LED light source is non-replaceable. Once end-of-life is reached, the whole luminaire will need to be replaced.

Basic insulation is provided between live and DALI control conductors.

Reconnect the electrical supply and test the installation.