

Surface Modules Cont.

Modules

2

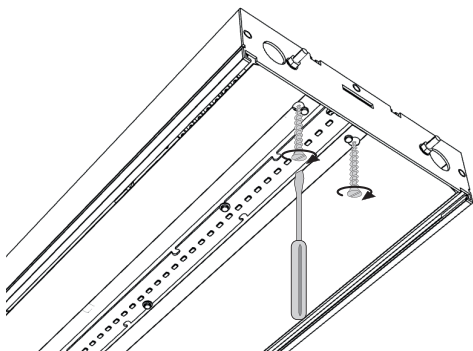

Spacer/Aleda Modules

3

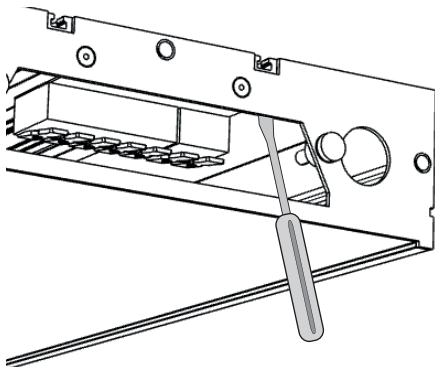

Wiring Information

	Non Dim/Emergency	DALI Dim/Emergency	Switch Dim/Emergency	PIR/PIR DALI/Emergency
Black	Unswitched Live (Emergency)	Unswitched Live (Emergency)	Unswitched Live (Emergency)	Unswitched Live (Emergency)
Brown	Switched Live	Unswitched Live	Unswitched Live	Unswitched Live for DALI PIR (Dimmable)
Green/Yellow	Earth	Earth	Earth	Earth
Blue	Neutral	Neutral	Neutral	Neutral
Orange	Not used	Not used	Not used	Unswitched Live for PIR (Switching only)
Red	Not used	DALI 1	Switched Live (DIM)	Not used
White	Not used	DALI 2	Not used	Not used

Installing Diffusers

1

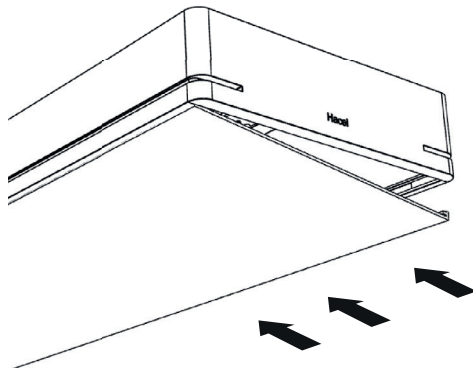

2

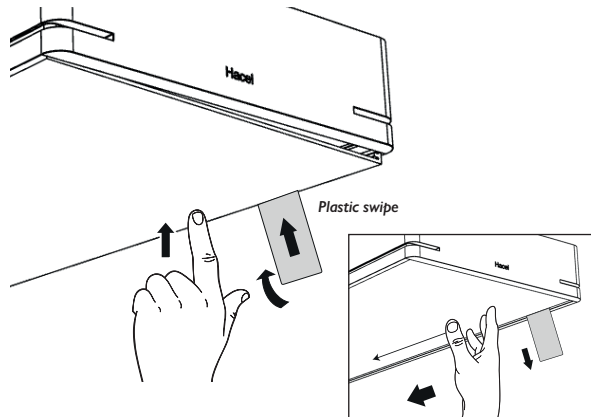

IMPORTANT INFORMATION

Linear Light5 Link/Solo

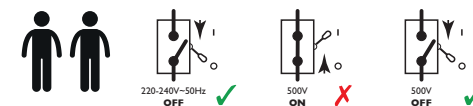

IMPORTANT Disconnect before High Voltage Insulation testing



IMPORTANT INFORMATION

- This Document and the Tool Kit must be left on site with the end user.
- Disconnect electricity supply before installation.
- To be installed by qualified personnel only.
- **Due to the weight of these luminaires, ensure suitable fixings are used when installing!**
- The Linear Light5 Wiring Harness is rated at 16A, therefore several mains/dimming supplies may be required for larger systems.
- When installing, Hacel recommends wearing disposable gloves to avoid fingerprinting to the paint work of the luminaire.
- For end of runs, a connector block is supplied with the end caps to allow cable termination and this can be pushed into holes on the gear tray.

Hacel[®]
Fluent in Lighting

THE SILVERLINK, WALLSEND, NEWCASTLE UPON TYNE,
TYNE & WEAR, NE28 9ND

TECHNICAL: (0191) 280 9914 E-MAIL: technical@hacel.co.uk
WEB: www.hacel.co.uk

Removing Diffusers

Module Diffusers

1

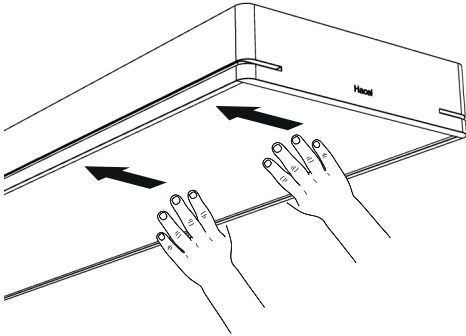

Push diffuser to create small gap between body.

2

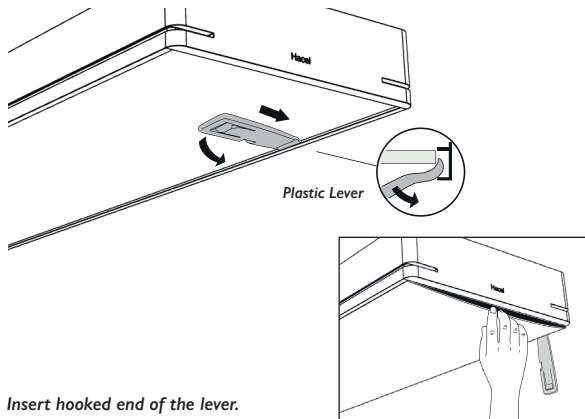

Insert hooked end of the lever.

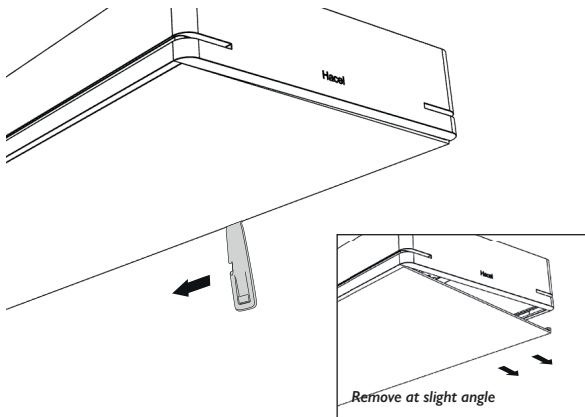

Remove at slight angle

Spacer/Aleda, L, T, X

Module Fascia's

1

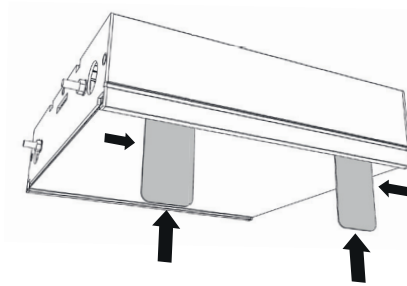

2

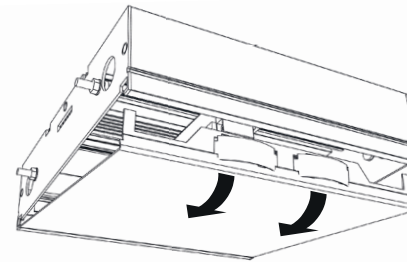

Suspended Modules

1

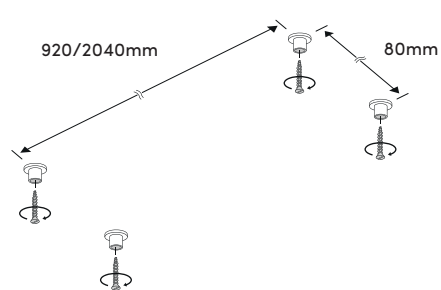

IMPORTANT

Due to the weight of these luminaires, ensure suitable fixings are used when installing!

Suspended Modules Cont.

2

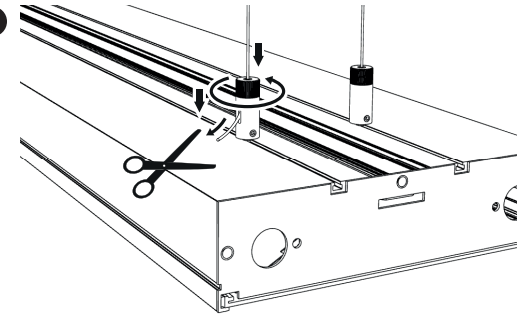

Re-tighten after levelling

3

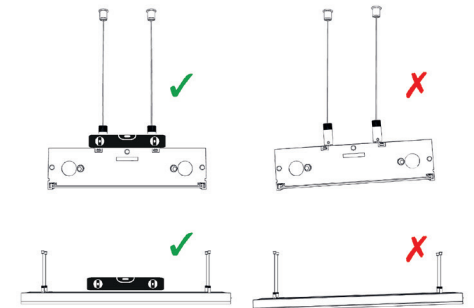

Surface Modules

1

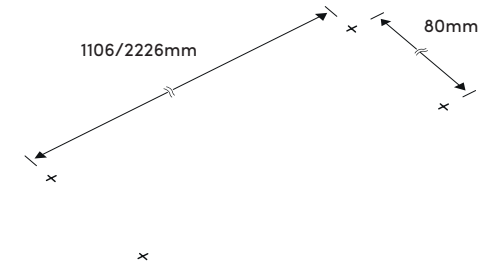

IMPORTANT

Due to the weight of these luminaires, ensure suitable fixings are used when installing!